



DGSM&DGRM Distribution Boxes

Product Discription

The DGSM and DGRM series distribution boxes have very attractive appearance with curve line, the cover color can be customized. The enclosure has very good intensity, can protect the internal equipments from shock impact and vibration. It also has fixed bracket and very simple structure to make the installation easy and quick.

Applications

- Equipped with various modular electric for the function of terminal power distribution
- Suitable for all CHT modular devices (RCDs, MCBs, RCBO's, Isolator etc.)
- Used in residential building, non-residential building, industry.

Technical Specifications

- Standard: IEC60493-3
- Approval: CB, CE
- Modules (No.): 4, 6, 8, 12, 18, 24, 36
- Row: Single row for 4, 6, 8, 12, 18 modules, 2 rows for 24 modules, 3 rows for 36 modules.
- Rated frame current $I_n(A)$: 63, 100
- Color: White body, transparent cover
- Mounting type: Surface and recessed
- Fire resistance: 650°C/30s
- Material: Polystyrene body, AS cover
- Ambient temperature (°C): -5°C ~ 40°C, max. 95% humidity
- Storage temperature (°C): -40 ~ 75

Fitting Inside The Enclosure

Attached with sticky label for marking on wire front panel; equipped with zero line and earth terminal bar and attached with zero bar, earth bar mark and alarm mark; users can select connection to wire or insulating busbar method.

Loops	Zero bar length	Zero bar holes	Earth bar length	Earth bar holes	Width	Height
Distribution box M	mm	piece	mm	piece	mm	mm
4	37	4M4X7+M4X7	29.5	3M4X7+M4X7	6	8
6	52	6M4X7+M4X7	29.5	3M4X7+M4X7	6	8
8	67	8M4X7+M4X7	37	4M4X7+M4X7	6	8
12	37+52	10M4X7+2M4X7	52	6M4X7+M4X7	6	8
18	74.5+37	13M4X7+4M4X7	74.5	9M4X7+M4X7	6	8
24	60+60+28+28	20M4X7+4M4X7	28+28	6M4X7+2M4X7	6	8
36	60+60+28+28	24M4X7+4M4X7	60+28	10M4X7+2M4X7	6	8

Product Dimentions(mm)

TMX-4-TMX-12

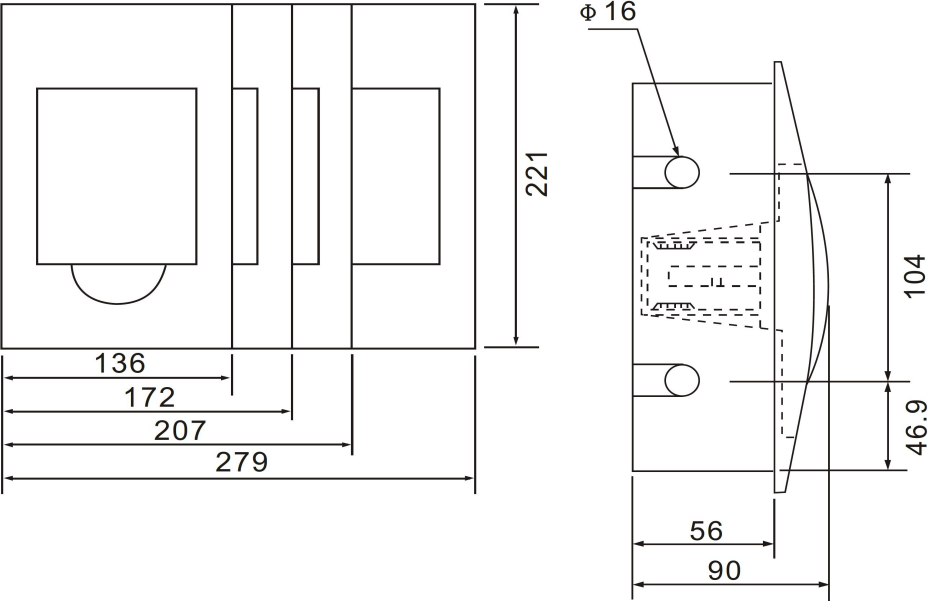

TMX-18

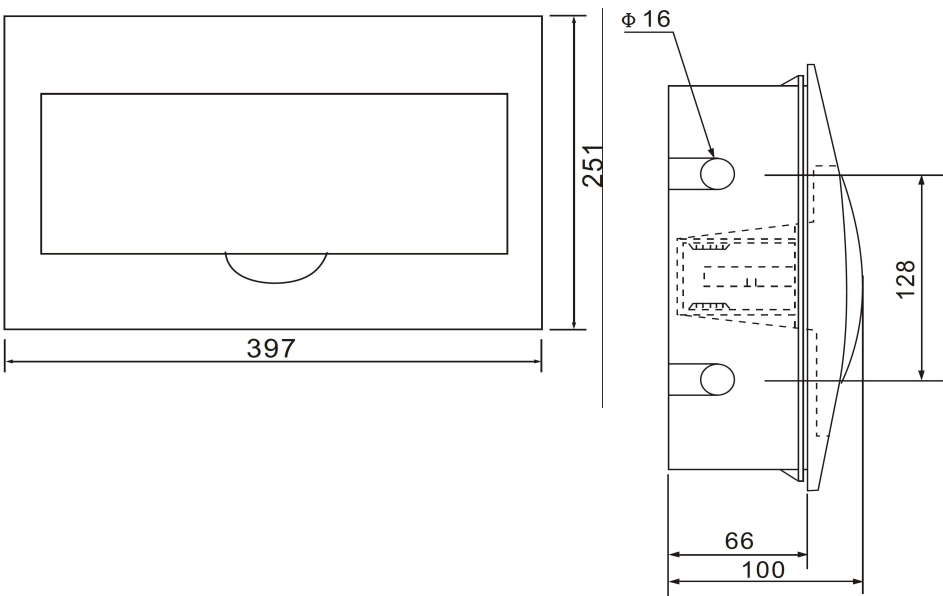

TMX-24

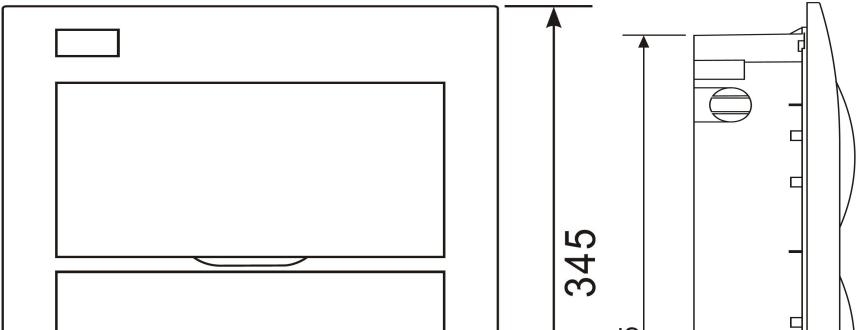

TMX-36

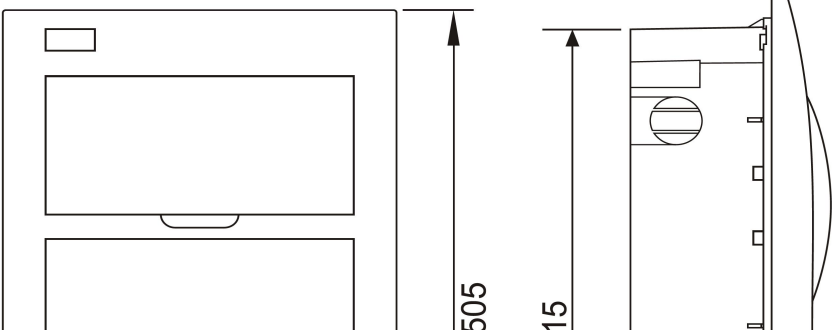

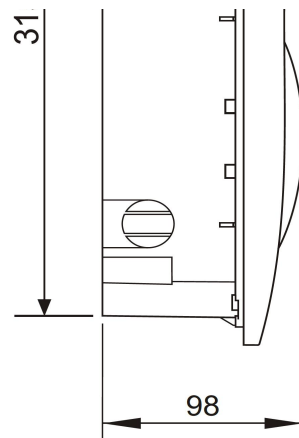
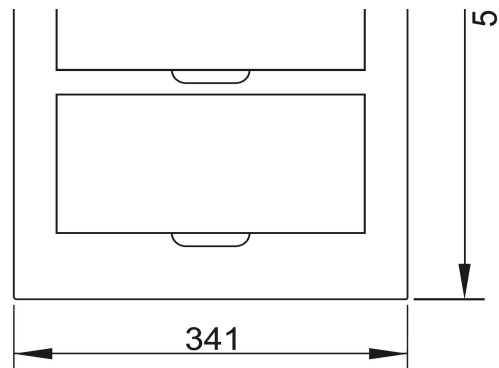
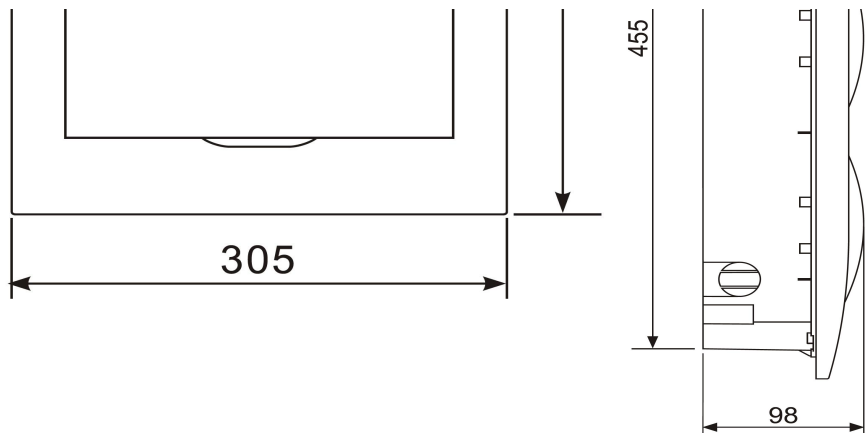

Installation Dimentions(mm)

